

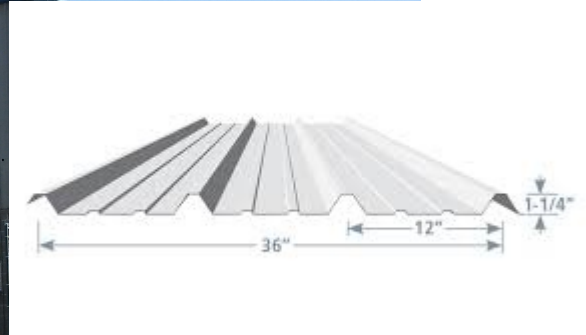

Steel Roofing and Siding Installation Guide

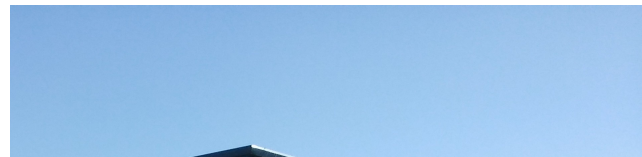

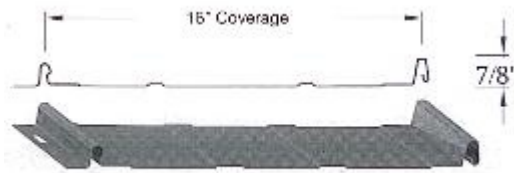

Read this guide in its entirety before beginning any installation

This installation guide is provided by Legacy Metalworks for our customers. This is not a complete guide for any and all situations. These instructions do not take the place or supersede any local or state building codes. Please check with your contractor, architect, or local building department for further assistance if needed.

We here at Legacy Metalworks do not assume any responsibility for injury, damage to property, or other problems which may come about as a result of improper installation or other usage of our products.

We may at any time change these drawings and specifications without obligation or notification of products previously purchased.

~

Although steel roofing is known for having very little need for upkeep and maintenance, things like low pitch, leaves, and other factors may result in cleaning needed to avoid holding moisture against the metal itself.

If you need to wash the roof, you can use a pressure washer and/or use a mixture of one cup detergent (containing less than .5% phosphate) mixed with five gallons of warm water.

Be careful when walking on the roof to avoid scuff marks and scratches to the finish.



- When installing, follow all OSHA safety requirements.
- Wear the proper safety gear, clothing, and eye and ear protection.
- Never work off of or stand on panels that are unfastened or only partially fastened.
- Be aware of potential hazards when working on the roof, such as other workers, edges, skylights, equipment, tools, etc.
- Remember that metal roofing panels can be slippery when wet or coated with dust, frost, or oil. Do not try to walk on panels when in unsafe conditions.
- Installing metal during windy conditions can be dangerous and should be avoided.

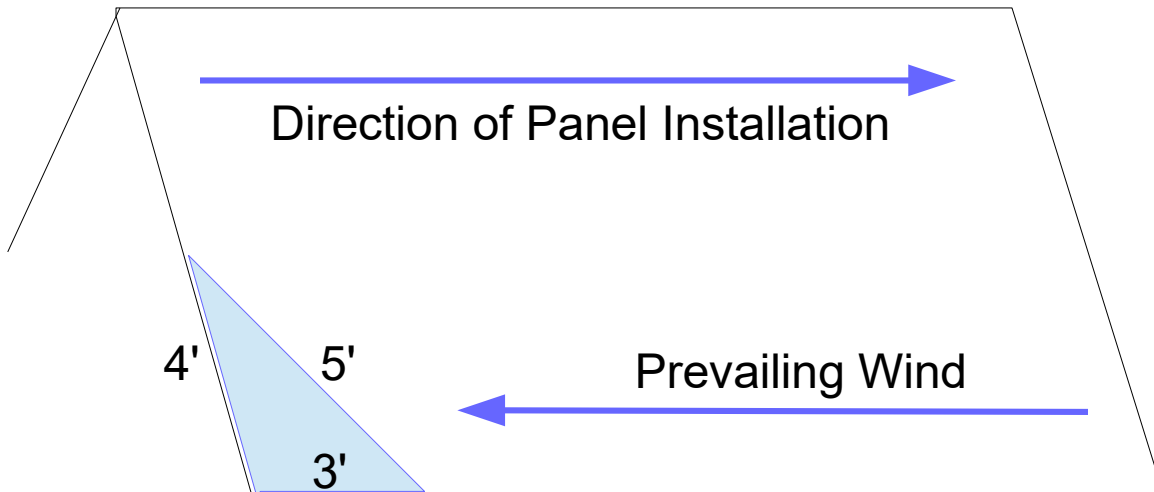

Before beginning the installation of panels, make sure you have put on all trims and underlayment that need to be put on first, before putting on the panels.

Always start with the over lap side on the side of the roof opposite the direction of the prevailing wind.

Start square by using a 3'x4'x5' right triangle or any multiples of these numbers. (6'x8'x10')

Try to align the first panel with the side of the roof. Seams such as panel over lapping and trim overlapping should be overlapped sufficiently and have a layer of butyl tape or weatherproof sealant.

We recommend overhanging our panels on the edge of the roof anywhere from 1" to 2".

When installing siding panels, don't run them all the way to the ground. Instead stop them a couple inches above with a base trim under them.



Hydrashell Underlayment



Hydrashell is a U.S. Made underlayment with a 30 year limited warranty. It is designed to lay flat and not wrinkle. Apply on a solid sheeting and fasten with staples or flat head nails. Fasten amply along the edges of the pieces. Put pieces of tape over your nail heads to avoid possibility of moisture penetration.

The longer it is exposed to the elements without being covered by metal, the more the possibility of the underlayment not doing it's job according to the specs.



Tuf-Rib

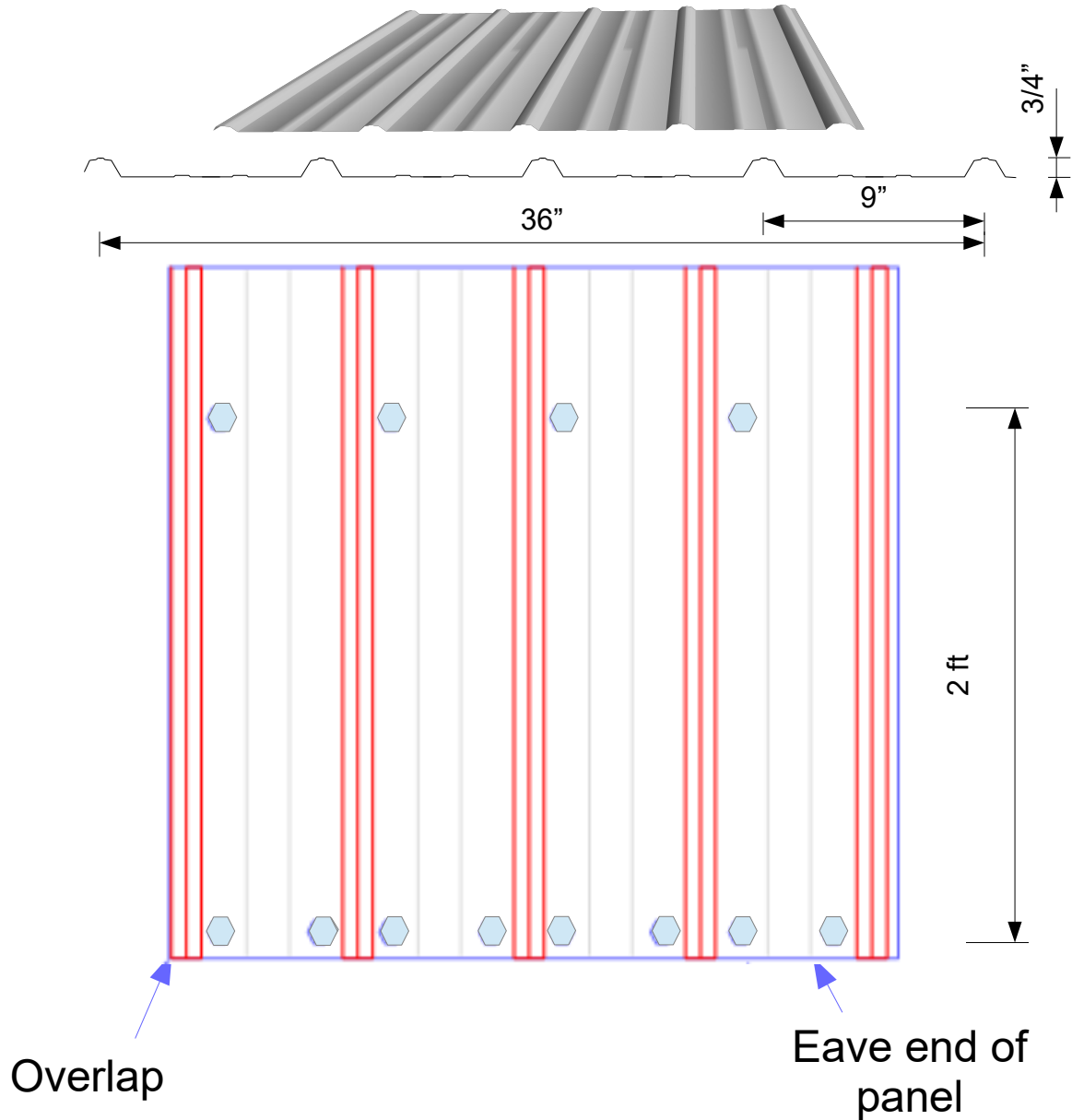

Screw the Tuf-Rib panel every two feet up the roof four screws per row. We recommend screwing on both sides of the ribs on the bottom edge of the panel.

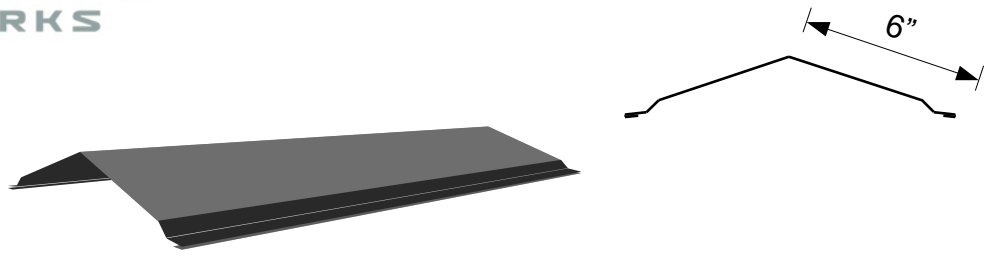

Ridge Cap

Install ridge cap on the peak of the roof. Screw in the lower flat of the ridge trim through foam closure into the rib of the panel.

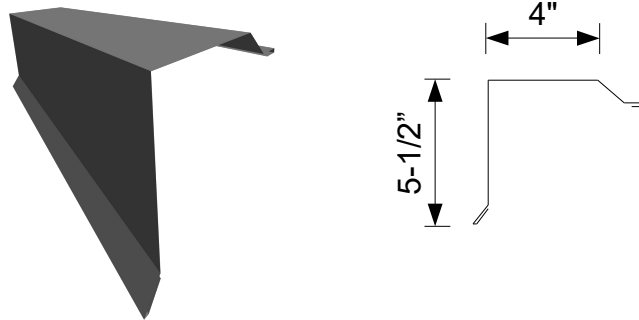

Gable Flashing

Install gable flashing along the edge of the panel. Fasten the trim piece through the top flange. Also screw through the side face into the wall.

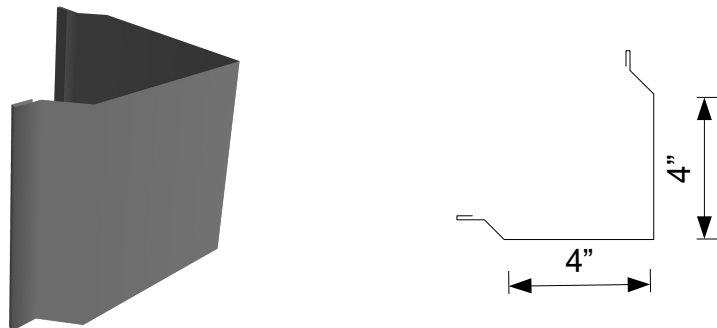

Outside Corner

Install outside corner piece of trim over the last rib of each side of each wall panel. Screw through the flanges on each side into the flat of the panel.

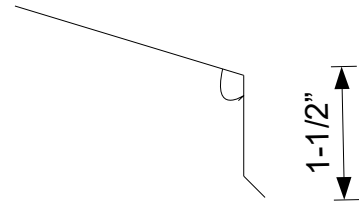
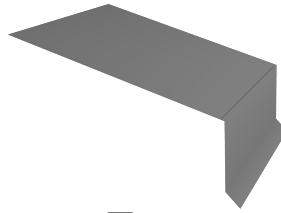

Eave

Install eave on the bottom edge of the roof before laying the panel on top of it. Putting foam closure between eave trim and panel is advisable to dissuade insects from getting up under your panel.

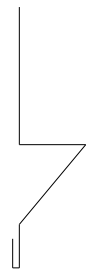
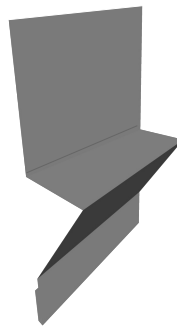

Rodent Guard

Rodent guard is used to block small animals from going up under your wall panels. Install it at the bottom of your wall panels like a base trim.

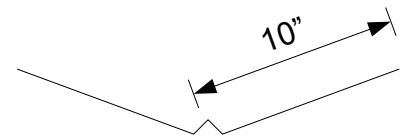
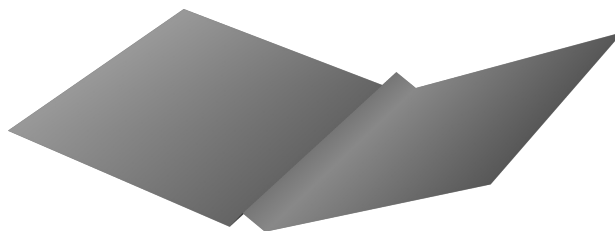

W-Valley

Install w-valley in the valley where two roof slopes come together. A roof sealant should be applied at the edge of the piece of trim on both sides.

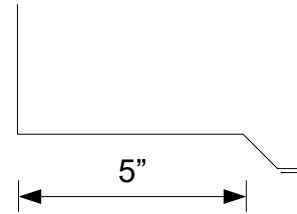
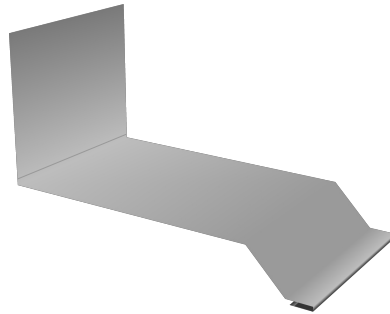

Sidewall

Install sidewall metal flashing where the side of the panel is running along an adjacent wall. Put the sidewall piece on over the panel and run the back leg up behind the siding.

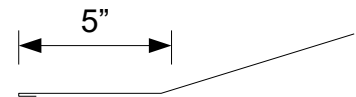
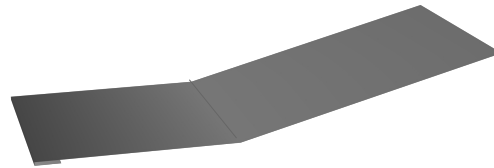

Endwall / Pitch Break

Install endwall where the end of the panel runs into the wall. Screw through the bottom face through the closure into the ribs of the panel. Tuck the back leg up under the siding/roofing that is above it.

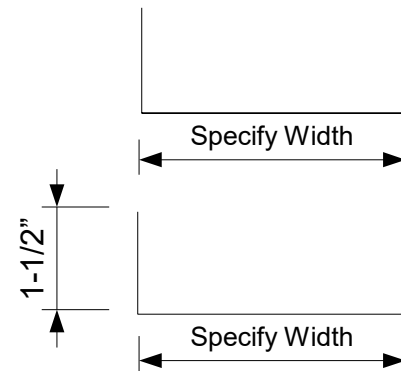
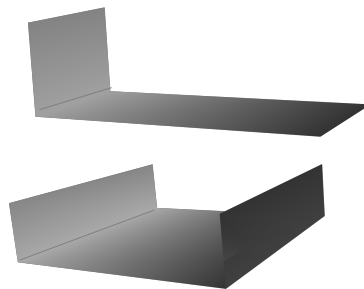

Jamb Cap

Install jamb cap trim around the boards surrounding the door opening. To install, nail through the side flanges or screw through the face of the jamb.